



# DeliverHealth

## **eScript One Mobile for iOS v3.8 Release Notes**

## What's new?

DeliverHealth is pleased to announce the release of eScripton One Mobile for iOS v3.8. This version includes the update below, as well as several minor bug fixes.

### Patient Mode Shows Only if Inpatient and Outpatient are Enabled

New in iOS Mobile v3.8, the 'Mode' section on the Settings screen will only be shown if the clinician has access to both Inpatient and Outpatient modes.

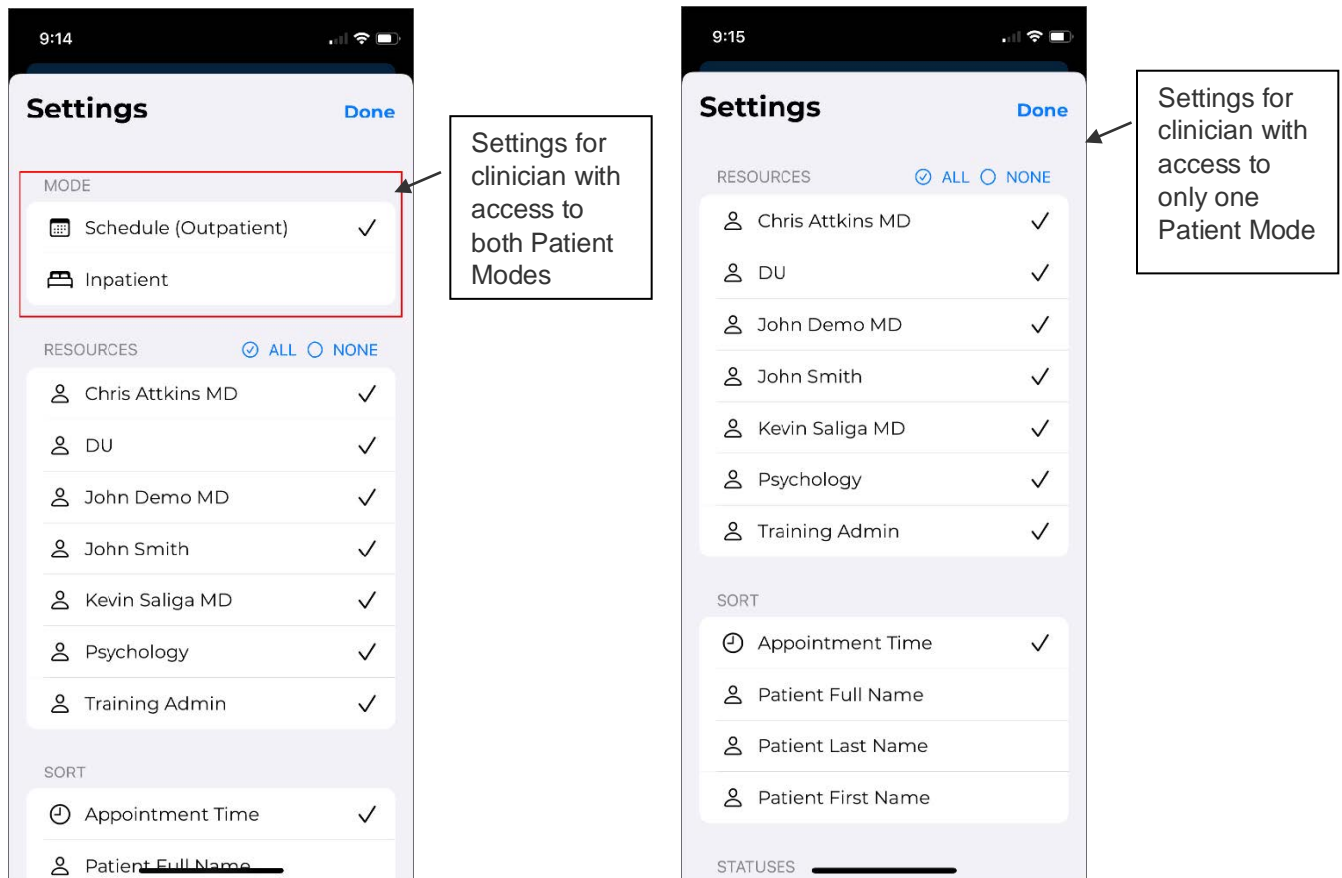

## Application Requirements

- Any iOS device with iOS 15.2 or greater. Open 'Settings' and tap 'About' then 'Software Version' to confirm that the OS installed is version 15.2+.
- Internet Access through a wireless Local Area Network (LAN) connection or through a phone service provider. It is strongly recommended to use a Wi-Fi LAN connection when uploading dictations. Minimum bandwidth: LTE/4G data connection; recommended is stable Wi-Fi.
- Communicates over port 443 to <https://mobile.escription-one.com> using TLS 1.2.