



DeliverHealth

eSOne Mobile for iOS v3.43 Release Notes

What's New?

DeliverHealth is excited to introduce the latest update for eSOne Mobile for iOS - version 3.43. This version adds support for Patient Displays. It also fixes an issue allowing completion when an additional signature was required.

Patient Displays – Additional Fields, Read-Only & Required Fields

Patient Displays are now fully supported in the Transcriptions tab of the eSOne mobile app for iOS. The Read-Only and Required Fields settings from Patient Displays are enforced and extended appointment fields are displayed based on Patient Display configurations.

Read-only fields will not be editable when a note is in edit mode and will be denoted by gray text. Required fields are denoted by red label text.

When users tap on fields configured with multiple data value choices while in edit mode, all available options will be listed; users can tap the desired value to select it.

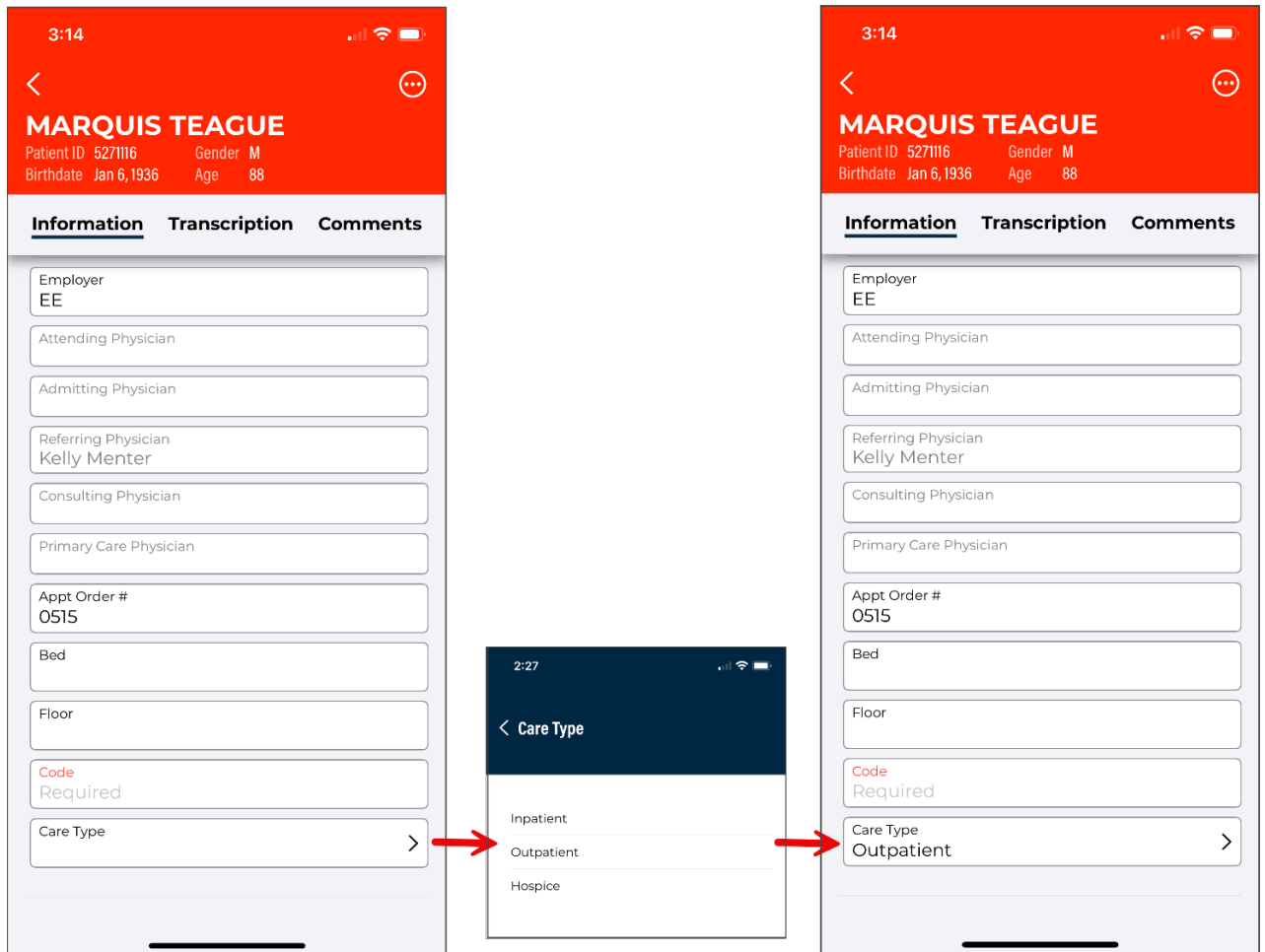

If mobile app users attempt to complete or save a note with missing data in a required field they will receive an informative message.

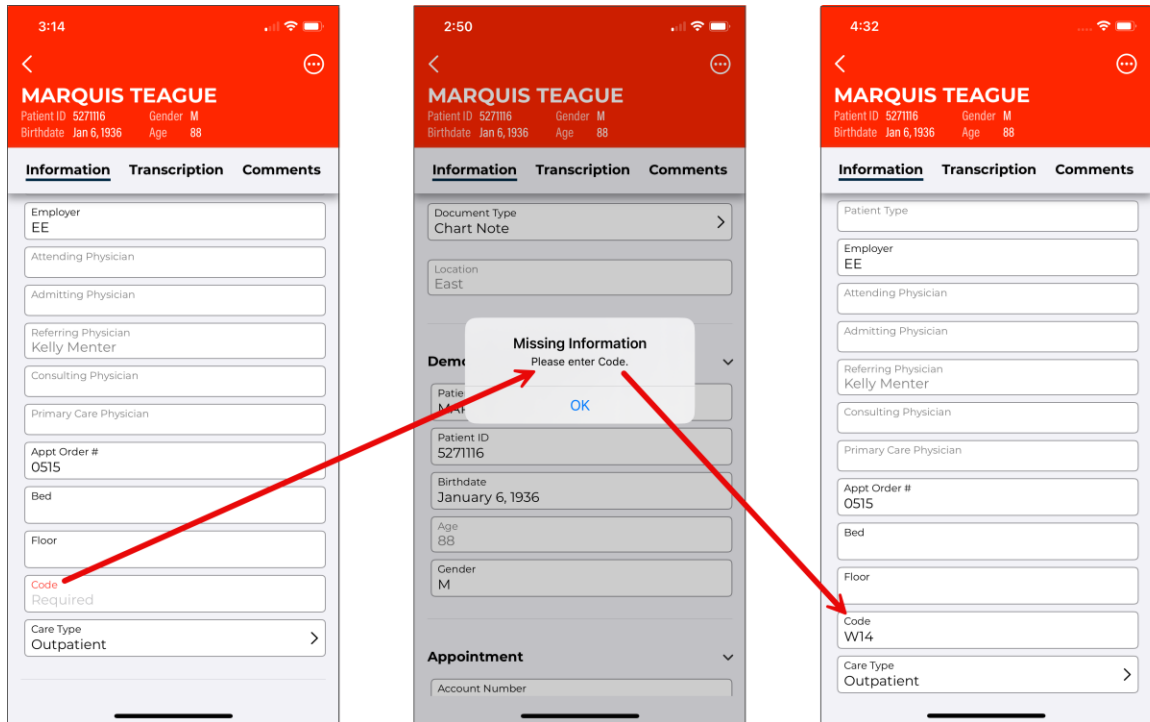

Note: Patient Displays can be configured in Client Maintenance and allow the patient demographic fields in the Info tab within the transcription viewer of the mobile app to be customized based on document type. Fields can also be marked as read-only or required. Patient Displays must be configured for the client to use this functionality.

Bug Fixes

- Notes requiring an additional signature can no longer be completed without an additional authenticator; a message will display informing the user an additional signature is required.

Minimum Application Requirements

- eScription One Mobile for Android necessitates an Android operating system receiving security updates from Android; Android OS 9 or higher.
- Internet access via a wireless LAN connection or through a phone service provider. We recommend a Wi-Fi LAN connection for uploading dictations. Minimum bandwidth requirements include LTE/4G data connection; stable Wi-Fi with 3 Mbps download/1 Mbps upload or greater is advisable.
- A microphone is required for dictation.
- Communication occurs over port 443 to <https://mobile.escription-one.com> using TLS 1.2.